

VENTILATOR type skylight

MONO FLAP VENTILATOR FOR SMOKE EXHAUST AND DAILY NATURAL VENTILATION



ACCORDING TO STANDARD
E N 1 2 1 0 1 - 2



MONO FLAP VENTILATOR

The **Skylight type ventilator**, is a mono flap ventilator designed to evacuate a great amount of smoke in case of fire, while maintaining high performance of thermal isolation.

MATERIAL

We can differentiate and select two main elements in this ventilator: base and flaps.

The **base** can be supplied **WITH** or **WITHOUT** isolation.

Insulation available: **20 or 40 mm.**

AL: ALUMINIUM.

ST: GALVANISED STEEL.

Coupling flanges.

The **flaps are manufactured as standard** in the following options:

AL: Aluminium flap.

AL-XPS: Aluminium flap with isolation from 20 or 40 mm.

PCA: Transparent or translucent polycarbonate or translucent from 10 to 25 mm.

PMMA: Transparent or translucent polymethylmethacrylate in 2 or 3 layers.

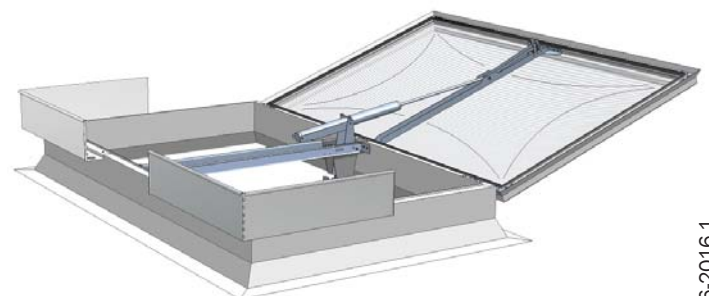
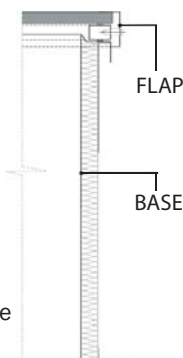

DECK roof type

Panel roof type

It is the ideal vent when it comes to horizontal or slightly inclined roof installation.

VENTILATOR type skylight

MONO FLAP VENTILATOR FOR SMOKE EXHAUST AND DAILY NATURAL VENTILATION



DIMENSIONS

Available dimensions:

HEIGHT: from 30 to 50 cm.

WIDTH: from 100 to 200 cm.

LENGTH: from 100 to 220 cm.

ANGLE of installation: 0° - 30°

SECURITY

The **skylight ventilator mcr-C type** is supplied with a security system that includes a secondary power source and an activation device consisting in a fuse element tared between 57 and 260 °C according to project requirements.



VENTILATION SYSTEMS

The devices can be made with a small electric motor with 230 V AC operation, which allows individual ventilator opening through a single button.



OPENING SYSTEMS

PNEUMATIC: Double acting cylinders.

ELECTRIC: Electric motors 24 V DC.

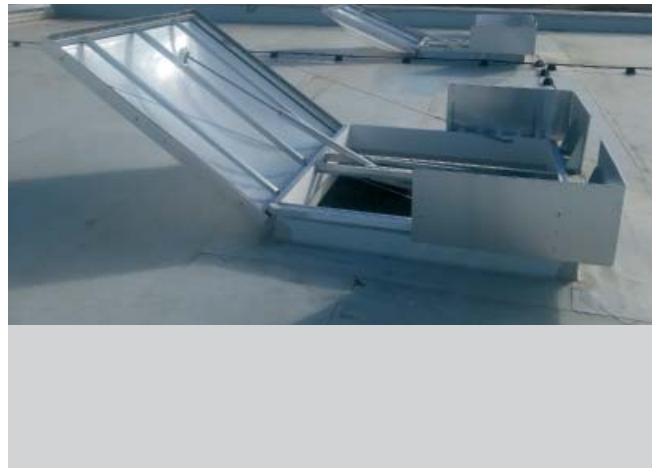

ADVANTAGES

High capacity of smoke exhaust

High capacity of thermal isolation

High capacity lighting

Allows the finishing of DECK roof type on its structure